

FLOOD INSURANCE STUDY

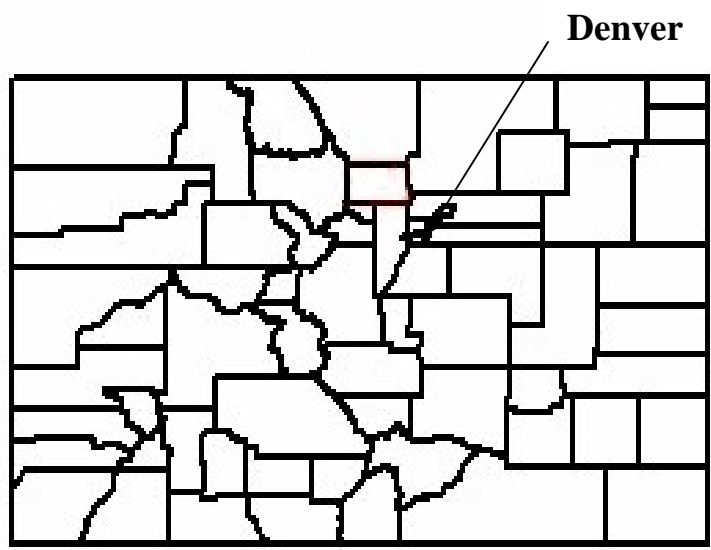

**CITY AND
COUNTY OF
DENVER,
COLORADO**
VOLUME 1 OF 2



REVISED: NOVEMBER 20, 2013



Federal Emergency Management Agency
FLOOD INSURANCE STUDY NUMBER
080046V001B

Table 2. Summary of Discharges (Cont'd)

Flooding Source and Location	Drainage Area (Square Miles)	10-Percent- Annual-Chance	Peak Discharges (cfs)		
			2-Percent- Annual-Chance	1-Percent- Annual-Chance	0.2-Percent- Annual-Chance
Sanderson Gulch					
At South Sheridan Boulevard (State Highway 95)	5.3	1,030	1,400	1,550	1,900
At West South Platte River Drive	7.6	1,650	2,200	2,450	3,000
Weir Gulch					
At Mouth	— ¹	1850	2340	2530	3190
First Avenue Tributary					
At Mouth	1.5	410	670	740	1030
Dakota Avenue Tributary					
At Mouth	0.7	200	300	355	465
Sand Creek					
Downstream of Confluence with Westerly Creek	184.0	10,000	22,400	30,000	33,000
Sand Creek Overflow					
1,030 Feet Above Confluence with Sand Creek	— ¹	— ¹	3,948	7,770	9,394
Sand Creek Smith Road Overflow					
At Divergence from Sand Creek	— ¹	— ¹	— ¹	420	726
South Platte River (Main Channel Only)					
At West Dartmouth Avenue	— ¹	6,400	12,700	16,500	31,500
At Alameda Avenue	— ¹	7,550	15,000	19,200	31,500
At 15th Street	— ¹	9,700	17,600	22,300	35,000
South Platte River (Franklin Street Overflow)					
At Divergence From South Platte River	— ¹	— ¹	— ¹	225	3875
Westerly Creek					
At Mouth	— ¹	3,680	5,780	6,790	9,150
At Colfax Avenue	— ¹	570	870	1,000	1,320
Westerly Creek Overflow					
At Confluence with Westerly Creek	— ¹	— ¹	— ¹	471	— ¹

¹ Data Not Available

FLOODING SOURCE		FLOODWAY			BASE FLOOD WATER-SURFACE ELEVATION			
CROSS SECTION	DISTANCE ¹	WIDTH (FEET)	SECTION AREA (SQARE FEET)	MEAN VELOCITY (FEET PER SECOND)	REGULATORY	FEET (NAVD)		INCREASE
						WITHOUT FLOODWAY	WITH FLOODWAY	
Sanderson Gulch								
A	118	140	715	4.7	5,247.1	5,247.1	5,247.1	0.0
B	450	70	442	5.6	5,247.5	5,247.5	5,247.5	0.0
C	623	106	531	5.3	5,252.0	5,252.0	5,252.0	0.0
D	689	114	460	8.5	5,252.3	5,252.3	5,252.3	0.0
E	900	30	468	7.1	5,261.5	5,261.5	5,261.5	0.0
F	1,570	128	538	6.6	5,262.9	5,262.9	5,262.9	0.0
G	1,878	170	341	9.7	5,264.1	5,264.1	5,264.1	0.0
H	1,895	184	616	6.1	5,269.4	5,269.4	5,269.4	0.0
I	2,289	125	645	5.3	5,270.6	5,270.6	5,270.6	0.0
J	2,305	110	564	6.0	5,270.6	5,270.6	5,270.6	0.0
K	2,657	120	253	13.1	5,271.1	5,271.1	5,271.1	0.0
L	2,784	156	1,515	2.2	5,283.0	5,283.0	5,283.0	0.0
M	3,150	130	1,385	2.4	5,283.1	5,283.1	5,283.1	0.0
N	3,229	125	1,270	2.7	5,283.1	5,283.1	5,283.1	0.0
O	4,044	85	488	6.9	5,283.4	5,283.4	5,283.4	0.0
P	4,074	62	257	11.6	5,284.4	5,284.4	5,284.4	0.0
Q	4,308	95	287	10.4	5,288.0	5,288.0	5,288.3	0.3
R	4,392	125	843	4.2	5,292.7	5,292.7	5,292.7	0.0
S	4,670	205	846	4.9	5,292.7	5,292.7	5,292.8	0.1
T	5,025	105	532	8.6	5,292.8	5,292.8	5,292.8	0.0
U	5,037	102	484	7.5	5,293.4	5,293.4	5,293.4	0.0
V	5,318	96	305	11.4	5,294.1	5,294.1	5,294.1	0.0
W	5,692	80	399	8.9	5,297.8	5,297.8	5,297.8	0.0
X	5,725	97	331	10.6	5,301.4	5,301.4	5,301.4	0.0
Y	6,206	88	791	4.1	5,305.7	5,305.7	5,305.7	0.0
Z	6,360	96	662	5.4	5,312.0	5,312.0	5,312.0	0.0

¹ Feet above mouth

TABLE 3

FEDERAL EMERGENCY MANAGEMENT AGENCY
CITY AND COUNTY OF
DENVER, CO

FLOODWAY DATA

SANDERSON GULCH

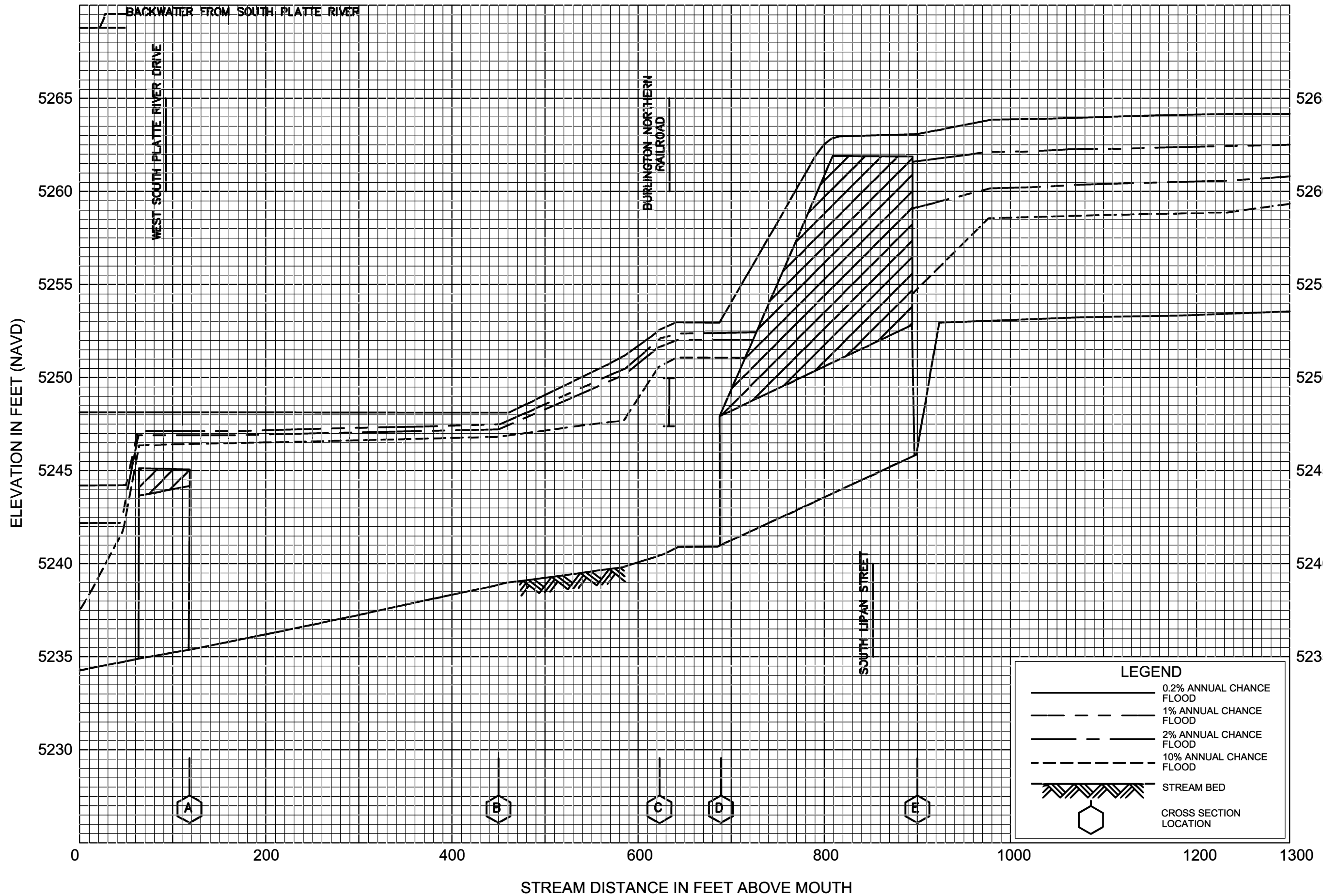

FLOOD PROFILES

SANDERSON GULCH

FEDERAL EMERGENCY MANAGEMENT AGENCY
CITY AND COUNTY OF DENVER, COLORADO

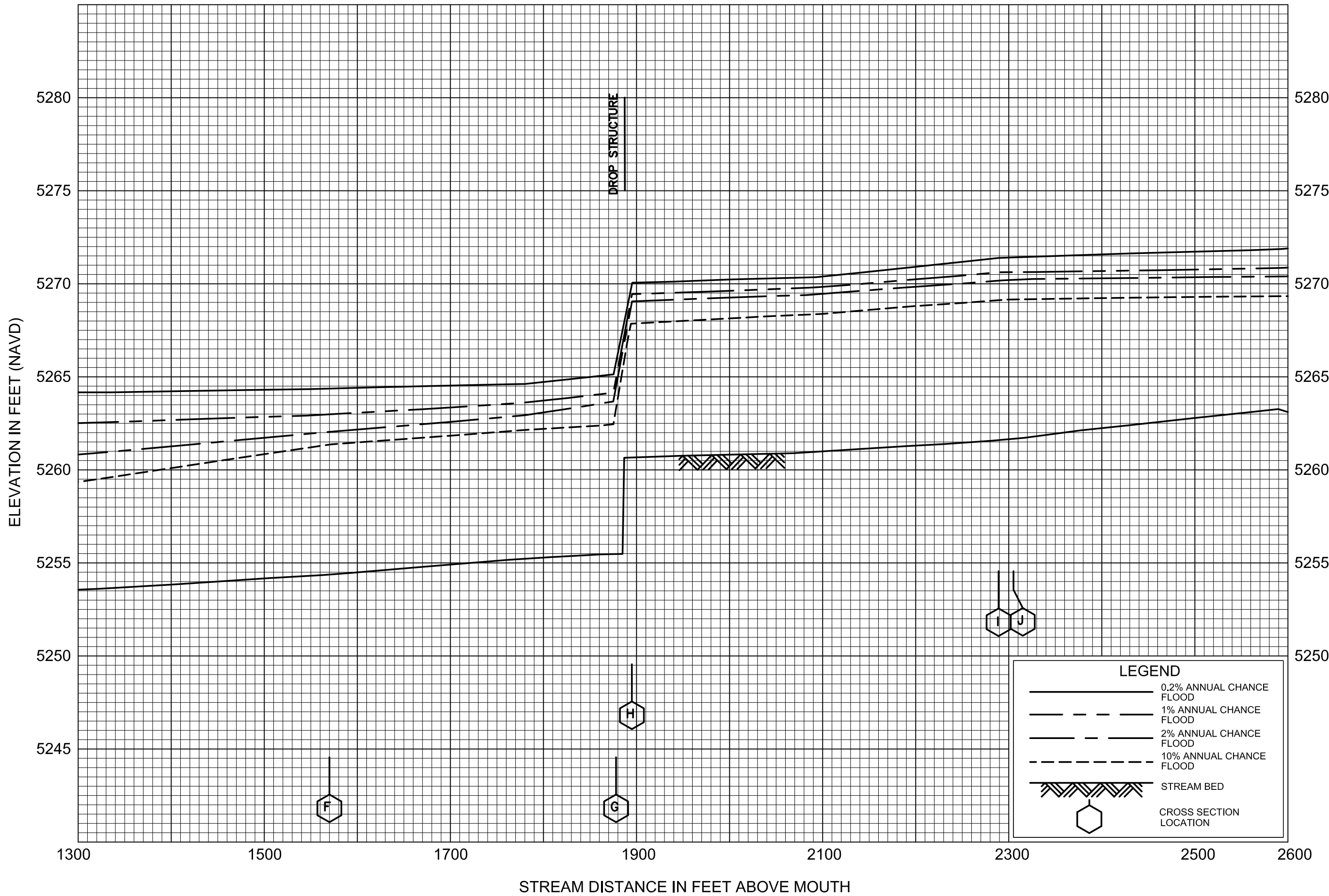

FLOOD PROFILES

SANDERSON GULCH

FEDERAL EMERGENCY MANAGEMENT AGENCY

CITY AND COUNTY OF DENVER, COLORADO

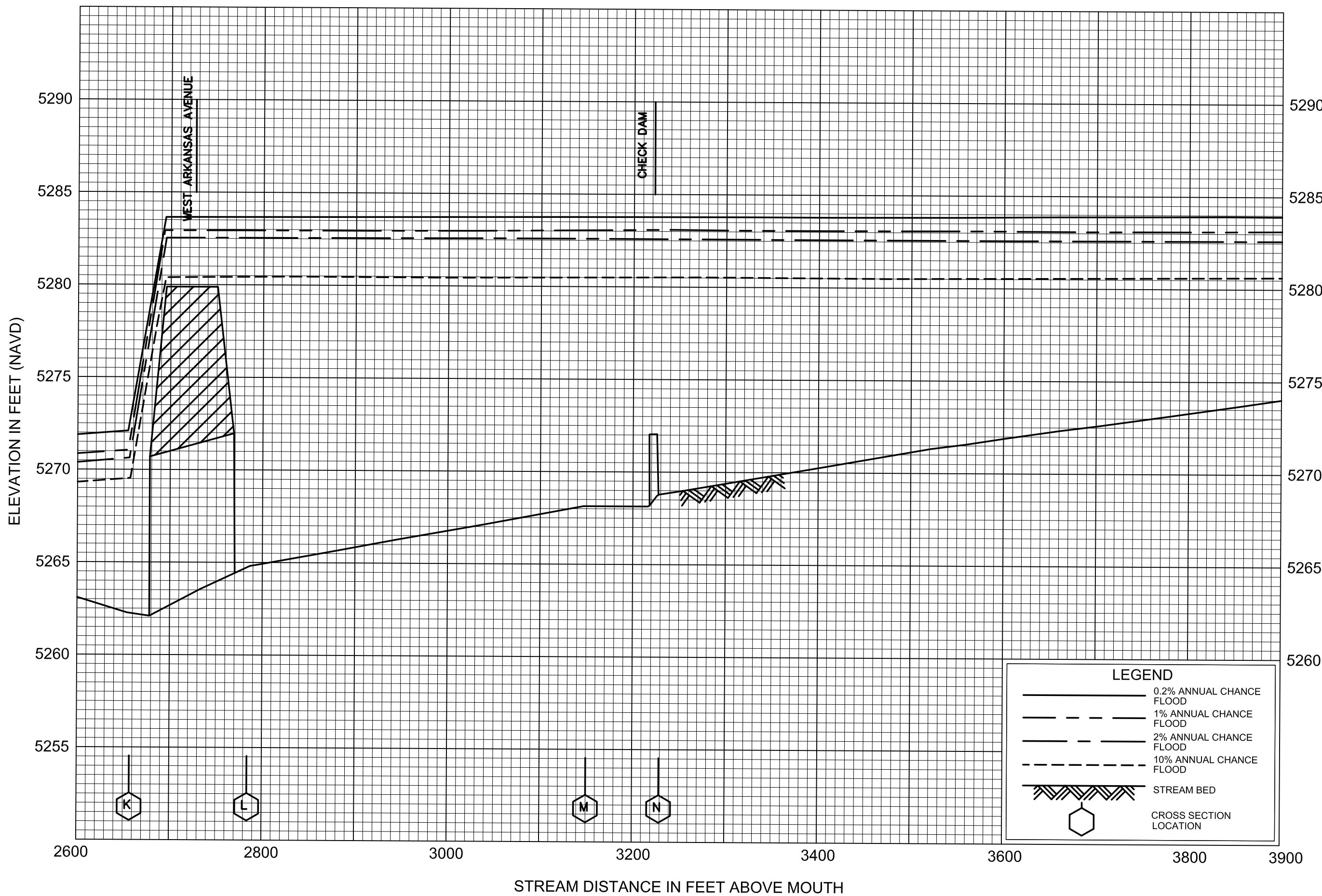

FLOOD PROFILES
 SANDERSON GULCH

FEDERAL EMERGENCY MANAGEMENT AGENCY
 CITY AND COUNTY OF DENVER, COLORADO

LEGEND

- 0.2% ANNUAL CHANCE FLOOD
- 1% ANNUAL CHANCE FLOOD
- 2% ANNUAL CHANCE FLOOD
- 10% ANNUAL CHANCE FLOOD
- STREAM BED
- CROSS SECTION LOCATION

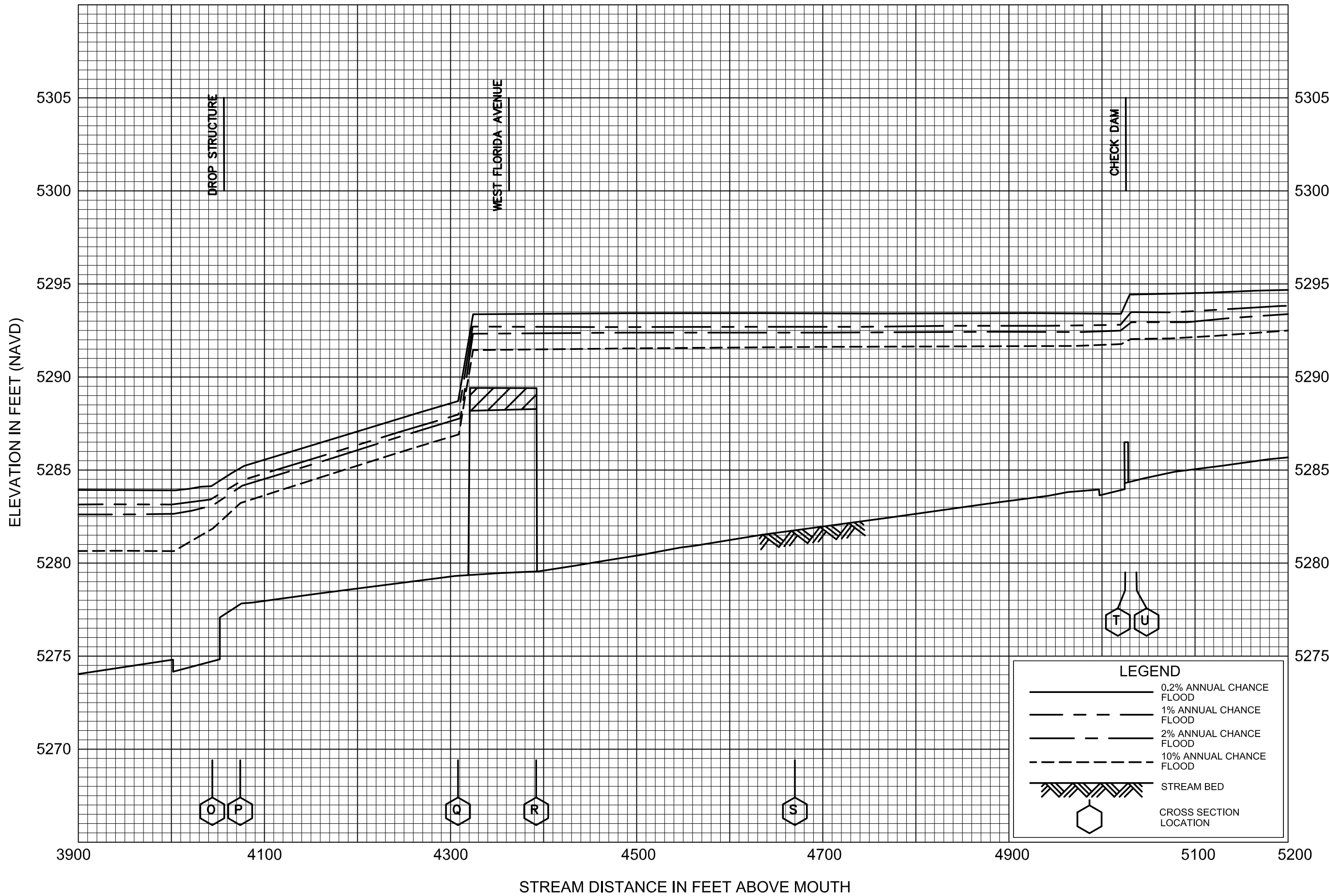

FEDERAL EMERGENCY MANAGEMENT AGENCY
 CITY AND COUNTY OF DENVER, COLORADO
 FLOOD PROFILES
 SANDERSON GULCH
 70P